

DeVorm

Split Lighting Series

Installation guide

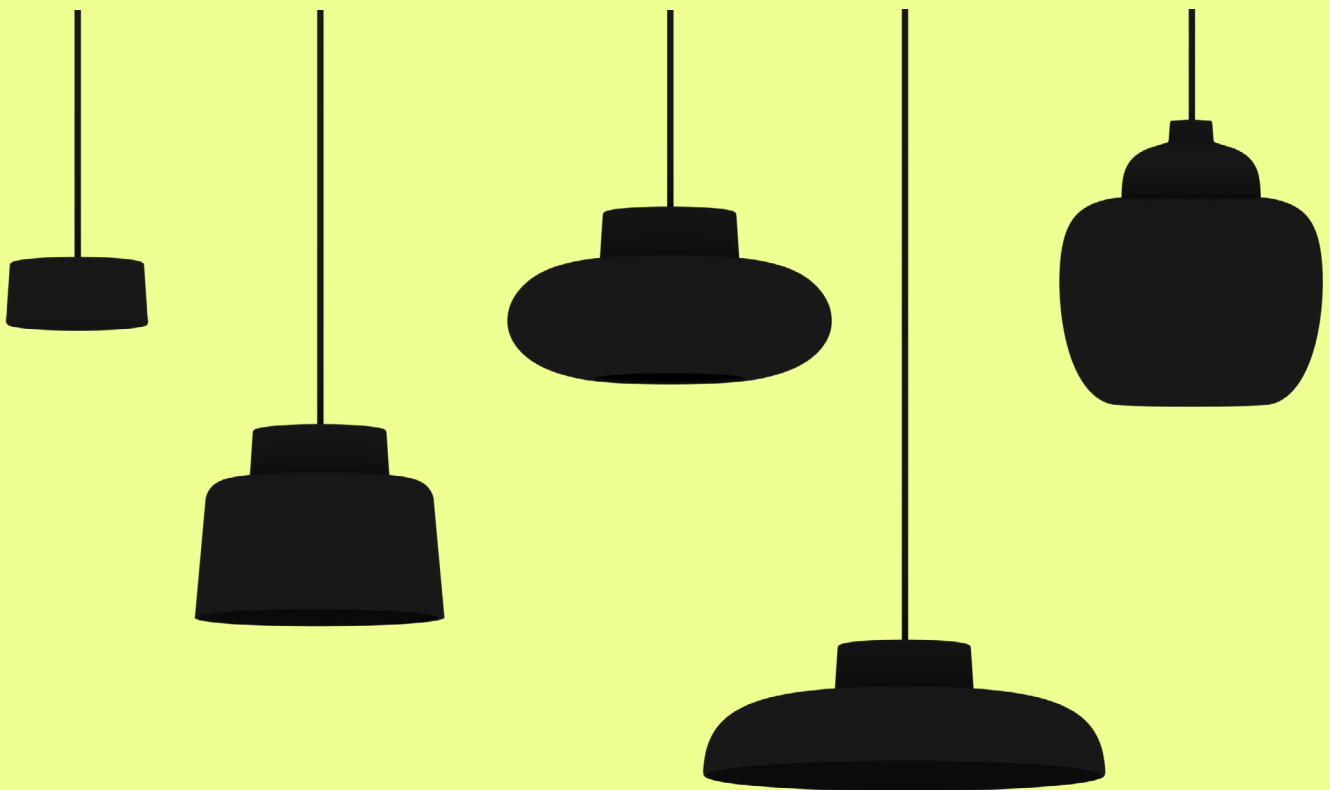

Introduction

- Follow the instructions for a safe installation.
- Make sure that the power supply has been turned off before installing or cleaning the product.
- Maintain interior lighting with a dry cloth or brush. Do not use alcohol or any other solvents to clean the product. Keep all electrical components dry. Make sure the power is switched off before cleaning this product.



Design

Jens Fager + De Vorm

About

Split Lighting Series brings a refreshing perspective to lighting in modern spaces. This innovative series is designed to meet the needs of architects, interior designers, and lighting professionals, offering a sleek, minimalist design that is both versatile and functional. Each lamp is crafted to adapt to the changing requirements of contemporary environments, ensuring that lighting is not just an afterthought but a central feature of design.

Specifications

LED module	LED GX53
Light output	410Lm
Voltage	100V-240V
Power	3W
Colour temperature	3000K / 4000K / 6500K
CRI	>80
Dimmable	No

Parts required

For Split Straight

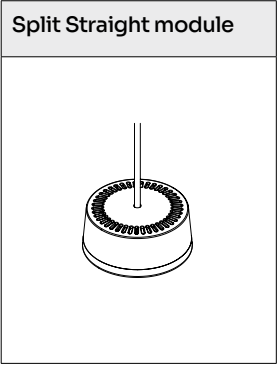

For Split Round

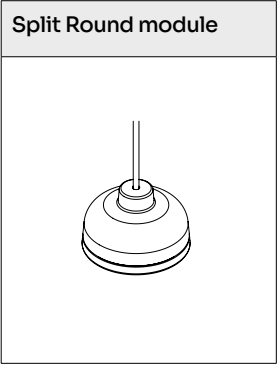

For versions with glass lampshade

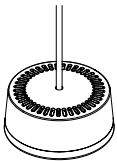
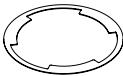
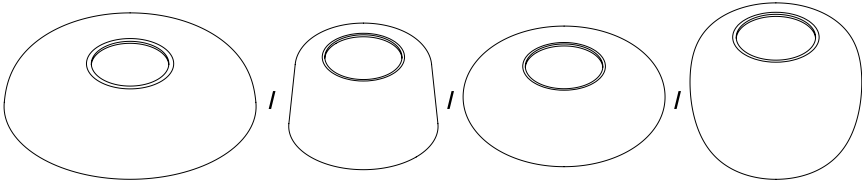
Split Straight / Round module	Gasket	Dome / Drum / Orbit / Acorn
		

Setting colour temperature

1 Twist the ring and detach it from the base.

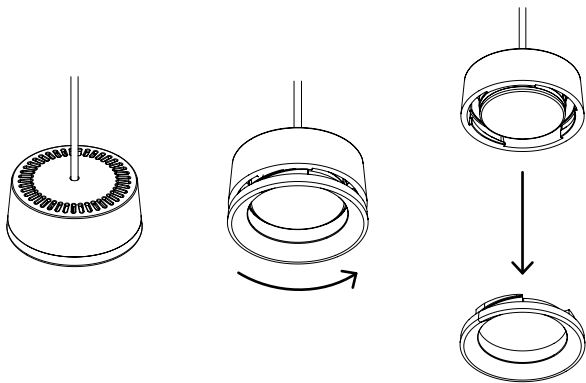

2 Twist the LED module and take it out of the lamp holder.

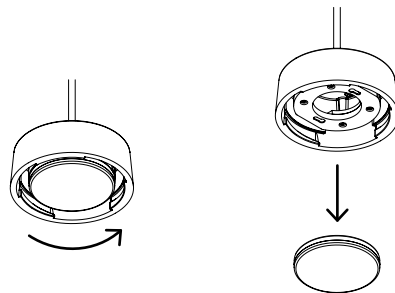

3 Use the switch on the backside of the LED module to set it to the desired colour temperature.

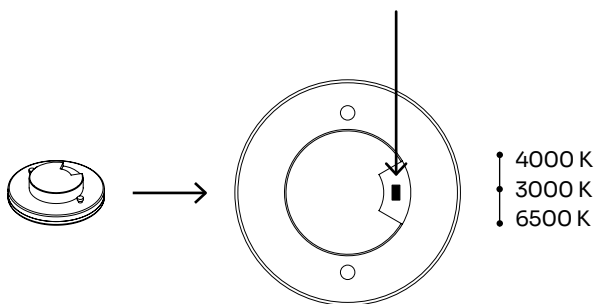

4 Put the LED module back in the lamp and reinsert the ring into the base.

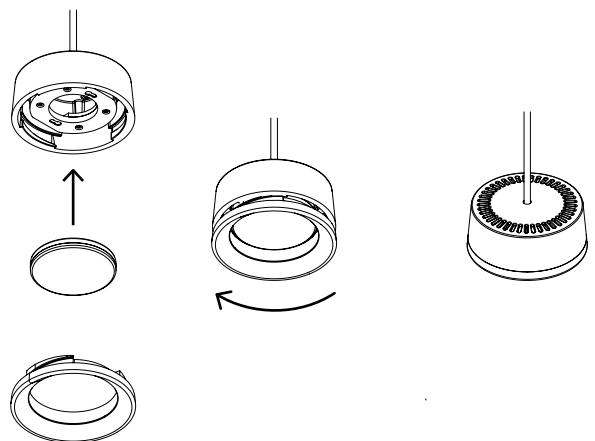

Adding glass lampshade

1 Twist the ring and detach it from the base.

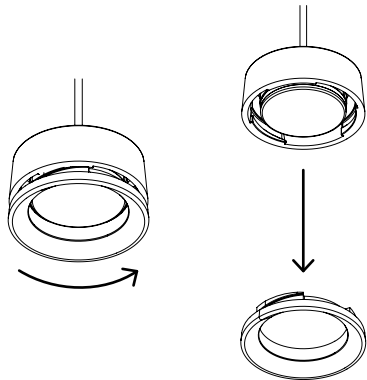

2 Make sure the gasket is placed on the ring and put the lampshade on top of both.

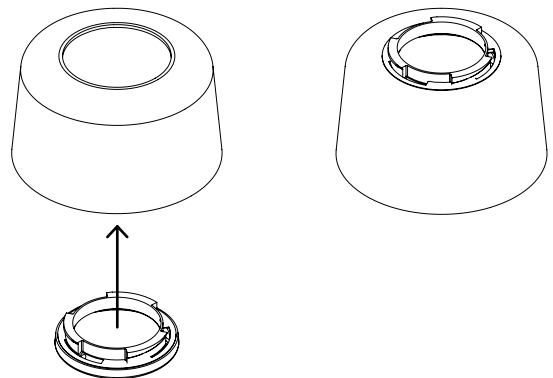

3 Put the second gasket on top of the lampshade.

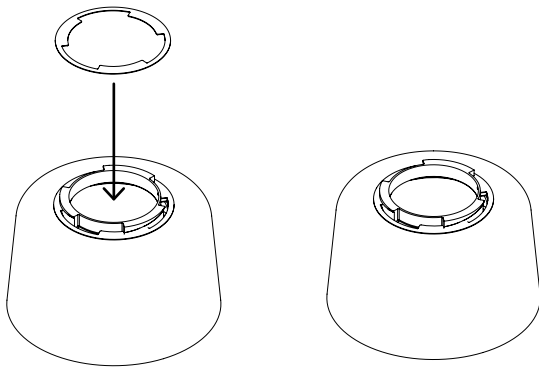

4 Finish the assembly by reattaching the base to the ring.

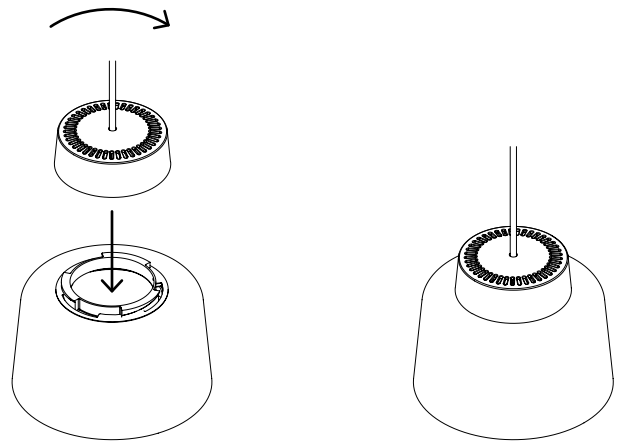

Connecting to power supply

1 Make sure the power is switched off.

2 Connect to power supply. You are all done!

Find us at
A Dijkgraaf 38
6921 RL Duiven
The Netherlands

Get in touch
T +31 (0) 26 820 03 60
E sales@devorm.nl
W www.devorm.nl

Stay up to date
IG [@de_vorm](https://www.instagram.com/de_vorm)
LI [/company/de-vorm](https://www.linkedin.com/company/de-vorm)
PIN [/devorm_interiorproducts](https://www.pinterest.com/devorm_interiorproducts)